

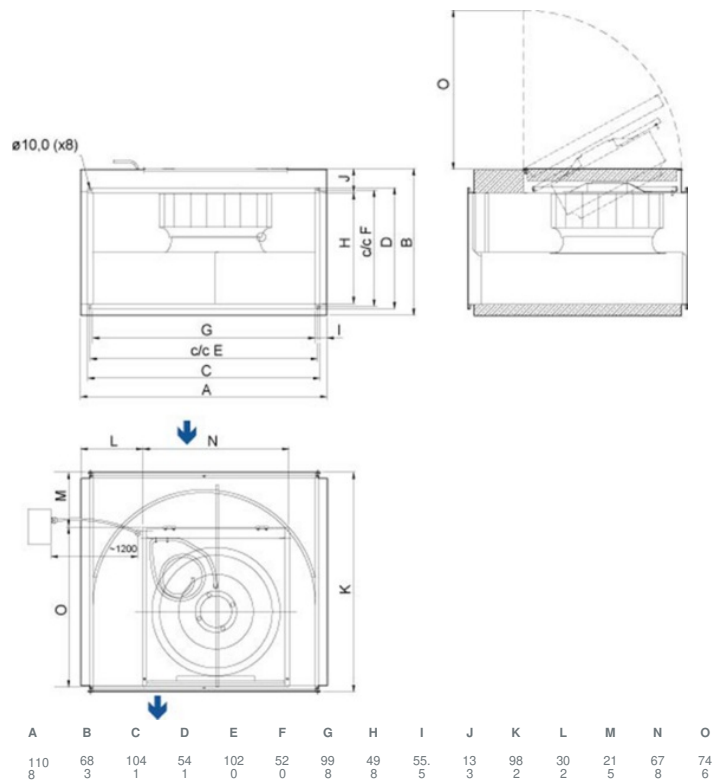

Technical parameters

Nominal data	
Voltage (nominal)	400 V
Frequency	50 Hz
Phases	3~
Input power	2,210 W
Input current	4.27 A
Impeller speed	1,368 rpm
Air flow	max 11,002 m ³ /h
Temperature of transported air	max 70 °C
Max temperature of transported air, when speed controlled	70 °C
Sound data	
Sound pressure level at 3m (20m ² Sabin)	65 dB(A)
Protection/Classification	
Enclosure class, motor	IP54
Insulation class	F
Data according to ErP	
ErP ready	ErP 2018
Dimensions and weights	
Duct dimension, inlet (height x width)	500 x 1,000 mm
Duct dimension, outlet (height x width)	500 x 1,000 mm
Weight	141 kg
Others	
Duct connection type	Rectangular
Motor type	AC

Dimension



400V 3~

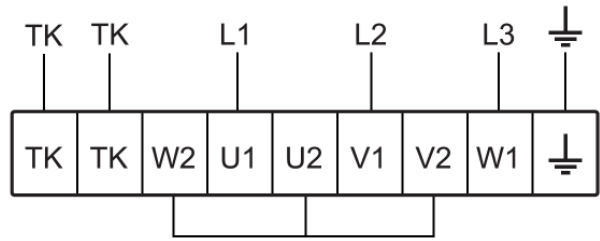

230V 3~



Performance curve

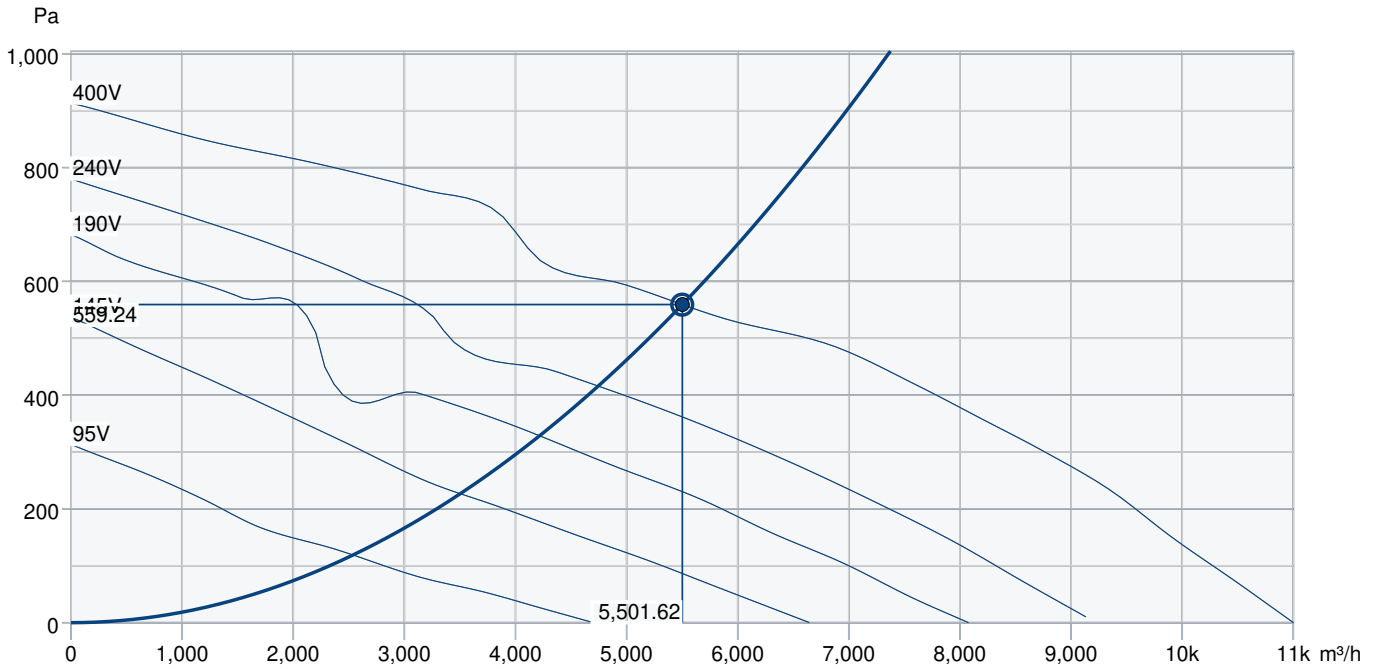

Hydraulic data	
Required air flow	5,500 m³/h
Required static pressure	559 Pa
Working air flow	5,502 m³/h
Working static pressure	559 Pa
Air density	1.204 kg/m³
Power	1,828.4 W
Fan control - RPM	1,390 rpm
Current	3.75 A
SFP	1.196 kW/m³/s
Control voltage	400.0 V
Supply voltage	400 V

Sound power level		63	125	250	500	1k	2k	4k	8k	Total
Inlet	dB(A)	67	75	70	71	67	64	59	55	79
Outlet	dB(A)	72	81	82	83	84	79	73	64	89
Surrounding	dB(A)	54	65	60	60	60	57	51	46	69
Sound pressure level at 3m (20m² Sabine)	dB(A)	-	-	-	-	-	-	-	-	62
Sound pressure level at 3m free field	dB(A)	-	-	-	-	-	-	-	-	48

Accessories

Accessories

DS 100-50 Flexible connection (1555)	Motor protect. switch S-DT 16 (161206)
Motor protect. switch S-DT 16E (161207)	REV-5POL/07-7,5kW R/Y (33980)
RTRD 7 speed control Systemair (5943)	RTRDU 7 Speed contr. Systemair (5947)
CO2RT-R-D Transmitter (6993)	DTV500A (96807)
HR1 Room Humidistat (215150)	Presence detector/IR24-P (6995)
RB 100-50/45-3 400V/3 Duct hea (9649)	RT 0-30 Room Thermostat (5151)
Safety switch 3-pole grey (210680)	T 120 Timer (5165)
DXRE 100-50-3-2,5 Duct cooler (7959)	FFK 100-50 filter cassette (30237)
LDR 100-50 Silencer (5067)	PGK 100-50-3-2,0 Duct cooler (6601)
RB 100-50/68-4 400V/3 Duct hea (9650)	RB 100-50/80-5 400V/3 Duct hea (9661)
VBR 100-50-2 Water heating bat (5470)	VBR 100-50-3 Water heating bat (5478)
Room hygrostat HR-S (286251)	TUNE-S-1000x500-M0 (421805)
TUNE-S-1000x500-M4 (421809)	TUNE-S-1000x500-M5 (421810)

Documents

INSTALLATION_OPERATION_AND_MAINTENANCE_INSTRUCTION_KE__KT__RS__RSI__EN_002.PDF
COMMISSIONING_RECORD_FANS__EN.PDF