

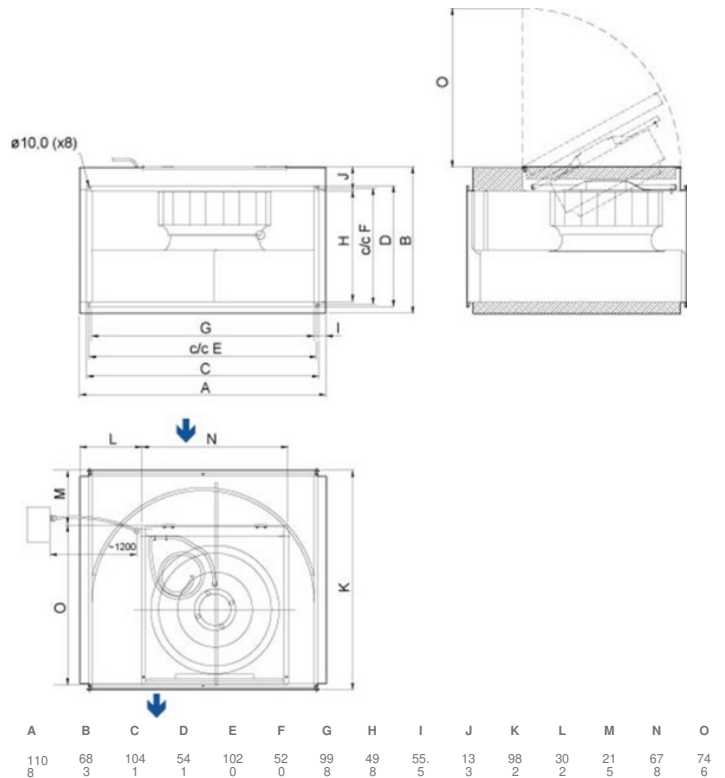

Technical parameters

Nominal data	
Voltage (nominal)	400 V
Frequency	50; 60 Hz
Phases	3~
Input power	2,075 W
Input current	3.21 A
Impeller speed	1,415 rpm
Air flow	max 11,250 m ³ /h
Temperature of transported air	max 40 °C
Max temperature of transported air, when speed controlled	40 °C
Sound data	
Sound pressure level at 3m (20m ² Sabin)	62 dB(A)
Protection/Classification	
Enclosure class, motor	IP54
Insulation class	F
Data according to ErP	
ErP ready	ErP 2018
Dimensions and weights	
Duct dimension, inlet (height x width)	500 x 1,000 mm
Duct dimension, outlet (height x width)	500 x 1,000 mm
Weight	135.6 kg
Others	
Motor type	EC

Dimension



Wiring

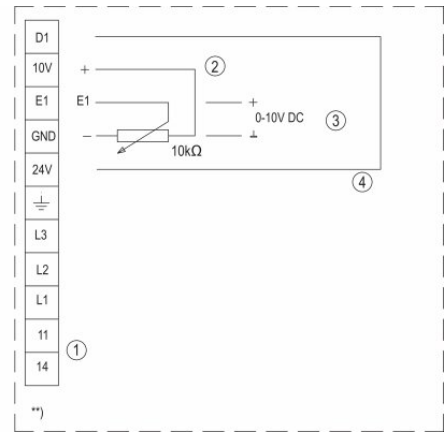
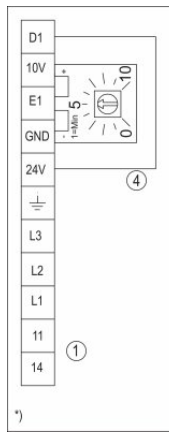

*) = Internal potentiometer

**) = External speed control

1 11 & 14 = Alarm

For operation the relay is energized, connections "11" and "14" are bridged.

For fault the relay is de-energized (Diagnostics/faults).

Contact rating max. AC 250V 2A.

2 External potentiometer

3 External input DC 0...10V

4 External ON / OFF control via potential free contact

Performance curve

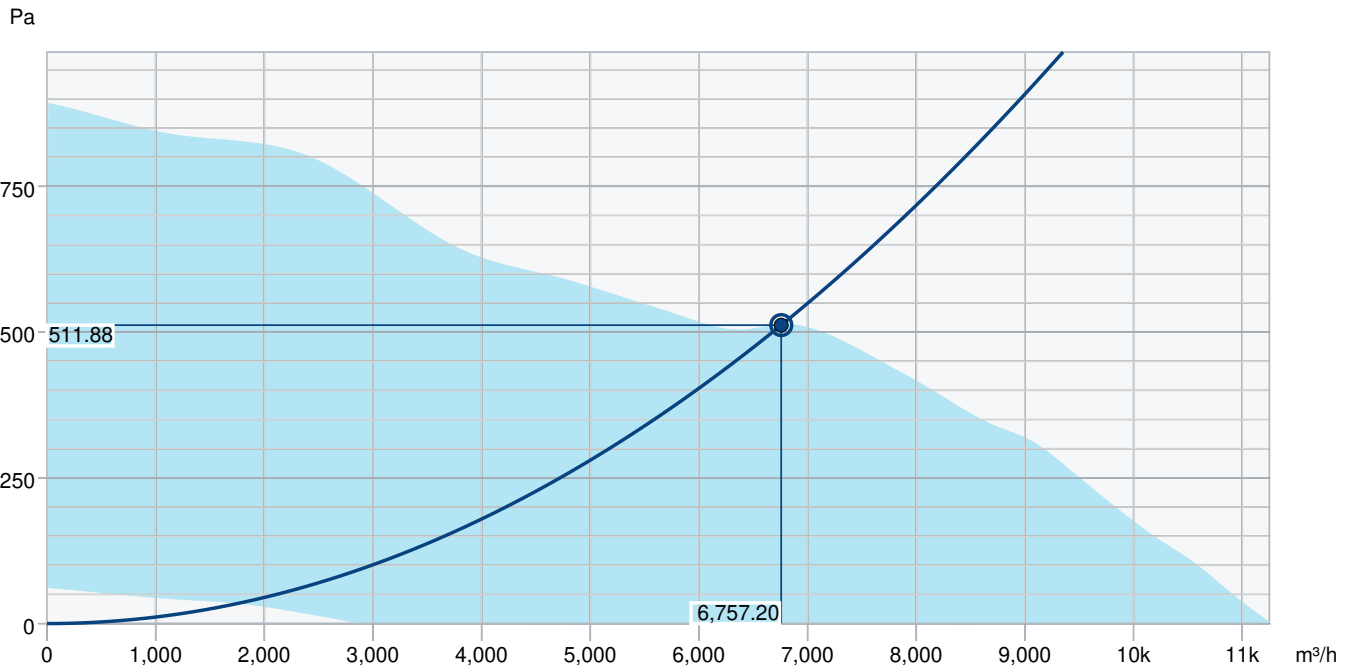

Hydraulic data	
Required air flow	6,758 m³/h
Required static pressure	512 Pa
Working air flow	6,757 m³/h
Working static pressure	512 Pa
Air density	1.204 kg/m³
Power	1,894.5 W
Fan control - RPM	1,413 rpm
Current	2.96 A
SFP	1.009 kW/m³/s
Control voltage	10.0 V
Supply voltage	400 V

Sound power level		63	125	250	500	1k	2k	4k	8k	Total
Inlet	dB(A)	67	79	74	75	72	68	64	57	82
Outlet	dB(A)	72	83	82	84	85	80	74	65	90
Surrounding	dB(A)	54	66	61	60	57	52	47	39	69
Sound pressure level at 3m (20m² Sabine)	dB(A)	-	-	-	-	-	-	-	-	62
Sound pressure level at 3m free field	dB(A)	-	-	-	-	-	-	-	-	48

Accessories

CXE/AVC Modbus (37256)	DS 100-50 Flexible connection (1555)
EC-Basic-CO2 and temperature (24808)	EC-Basic-H humidity (24807)
EC-Basic-T temperature (24805)	EC-Basic-U universal 0-10V (24806)
EC-Selector (9908)	EC-Vent control board (3115)
EC-Vent Room Unit (3018)	MTP 10, 10K, Speed control (32731)
MTV-1/010 Controller 0..10V+ (30650)	Potentiometer MTP 20, 0-10V (310220)
REV-5POL/07-7.5kW R/Y (33980)	Step switch S-5EC-2, 0-10V (449084)
CO2RT-R-D Transmitter (6993)	DTV500A (96807)
HR1 Room Humidistat (215150)	Presence detector/IR24-P (6995)
RB 100-50/45-3 400V/3 Duct hea (9649)	RT 0-30 Room Thermostat (5151)
Safety switch 3-pole grey (210680)	T 120 Timer (5165)
DXRE 100-50-3-2.5 Duct cooler (7959)	FFK 100-50 filter cassette (30237)
LDR 100-50 Silencer (5067)	PGK 100-50-3-2,0 Duct cooler (6601)
RB 100-50/68-4 400V/3 Duct hea (9650)	RB 100-50/80-5 400V/3 Duct hea (9661)
VBR 100-50-2 Water heating bat (5470)	VBR 100-50-3 Water heating bat (5478)
Room hygrostat HR-S (286251)	TUNE-S-1000x500-M0 (421805)
TUNE-S-1000x500-M4 (421809)	TUNE-S-1000x500-M5 (421810)

Documents

INSTALLATION_OPERATION_AND_MAINTENANCE_INSTRUCTION_KE__KT__RS__RSI__EN_002.PDF
 COMMISSIONING_RECORD_FANS__EN.PDF