

MV EC 100



MV EC 125



Dimensions MV EC 100

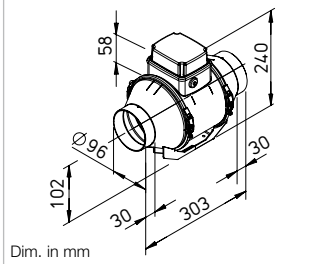

Dimensions MV EC 125

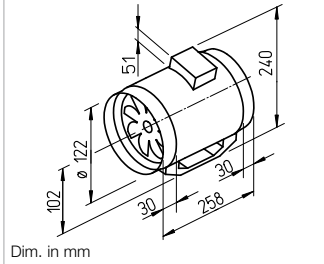

Energy-saving EC round duct fan with high pressure performance, high volume output and space-saving dimensions.

Specifically designed for direct insertion in duct systems. Various applications in commercial, industrial and residential areas.

Description

- **Casing**
The fan unit can be removed from the duct casing with integrated mounting bracket by loosening the clamp. All components are made of impact-resistant and corrosion-resistant plastic. Colour: Light grey.
- **Impeller**
Optimised for high pressure performance and volume output, made of high-quality plastic. Dynamically balanced for low-noise operation.
- **Drive**
Energy-saving, speed-controllable EC external rotor motor with the highest level of efficiency. Maintenance-free and radio interference-free, ball bearing mounted.
- **Electrical connection**
Spacious terminal box (IP44) on outside of casing; can be rotated into any position.

- **Motor protection**
Integrated electronic temperature monitoring system for EC motor and electronics.
- **Power control**
Continuously variable speed control via internal (delivery) or external potentiometer or continuously variable speed regulation with universal control system (see table). Performance levels are shown in the performance curve as an example.
- **Installation**
No restrictions in any position (horizontal, vertical, diagonal) through corresponding installation for supply or extract ventilation. Installation in duct system, preferably away from the room to be ventilated for less noise.

- **Noise**
The total level and range are specified above the performance diagram for:
 - Case-radiated sound power.
 - Inlet side sound power
 - Outlet side sound power.
 The case-radiated noise as sound pressure at 1 m (free field conditions) is also specified in the type table and the table below the performance curve.

Performance curves MV EC 100

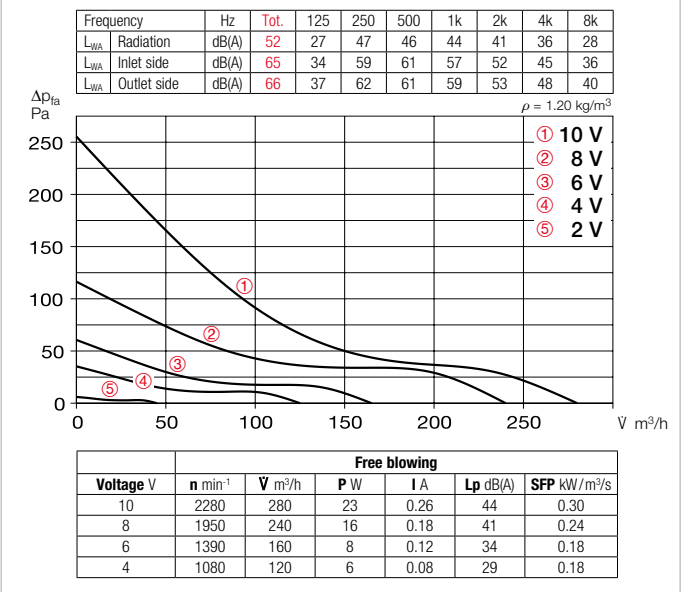

Performance curves MV EC 125

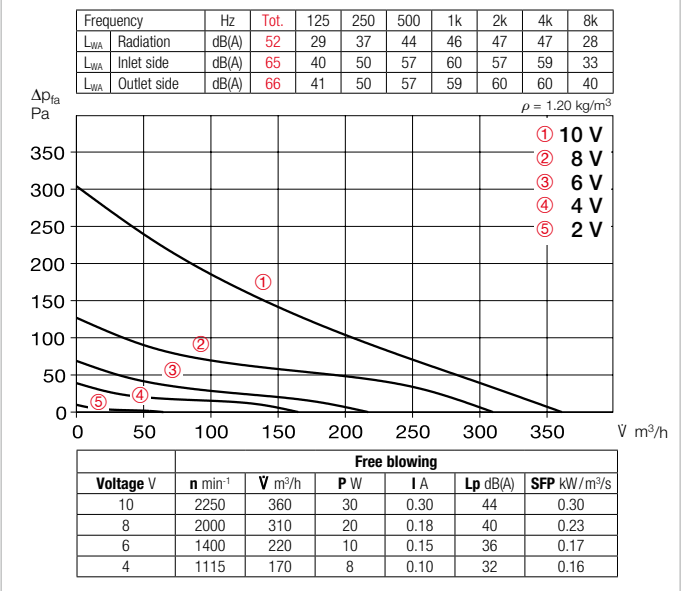

Accessory details	Page
Filters, heating elements and silencers	481 ff.
Temperature control systems for heating elements	487, 491 ff.
Flexible ventilation ducts, ventilation grilles, fittings, roof outlets	561 ff.
Disc valves	582 ff.
Universal control system, electronic controllers, speed potentiometer	613 ff.

Type	Ref. no.	Connec- tion Ø	Flow rate Free blowing	Rated speed	Sound press. case radiation	Power consum.	Current consum.	Wiring diagram	Max. air flow temp.	Wgt net aprx.	Universal control system		Speed potentiometer		
											Type	Ref. no.	Type	Ref. no.	
	mm	V m ³ /h	min ⁻¹	dB(A) in 1 m	kW	A	No.	+ °C	kg	Type	Ref. no.	Type	Ref. no.	Type	Ref. no.
Single-phase alternating current, 230 V, 50/60 Hz, EC motor, IP45															
MV EC 100	09513	100	280	3250	44	0.029	0.31	1194	60	1.8	EUR EC ¹⁾²⁾ 01347	PU 10 ¹⁾ 01734	PA 10 ¹⁾	01735	
MV EC 125	06032	125	360	3600	44	0.039	0.39	1194	60	1.8	EUR EC ¹⁾²⁾ 01347	PU 10 ¹⁾ 01734	PA 10 ¹⁾	01735	

¹⁾ Multiple EC fans can normally be connected. ²⁾ alternative electronic diff. pressure/ temperature controller (EDR/ETR, No. 01437/01438) or three level speed switch (SU/SA, No. 04266/04267), see accessories.