

Technical Data Sheet

CODE 42217

MPC-E 354 M

Medium-pressure long cased axial fans



Certifications

CE CE

EAC EAC

TECHNICAL AND PERFORMANCE DATA

| | | | |
|-------------------------------------------------------|------|-----------------------------------|------|
| Frequency (Hz) | 50 | Number of poles | 4 |
| Insulation class | I° | Voltage (V) | 230 |
| IP | X4 | Weight (Kg) | 13,4 |
| Max absorbed current (A) | 0,70 | Max airflow (l/s) | 875 |
| Max absorbed power (W) | 152 | Max airflow (m³/h) | 3150 |
| Max ambient temperature for continuous operation (°C) | 70 | Max pressure (mmH2O) | 17.2 |
| Min continuous operation room temperature (°C) | -25 | Max pressure (Pa) | 169 |
| Nominal diameter (mm) | 350 | RPM | 1450 |
| Number of phases (Ph) | 1 | Sound power Lw [dB(A)] | 57.3 |
| | | Sound pressure Lp [dB (A)] at 3 m | 36.8 |

DIMENSIONS

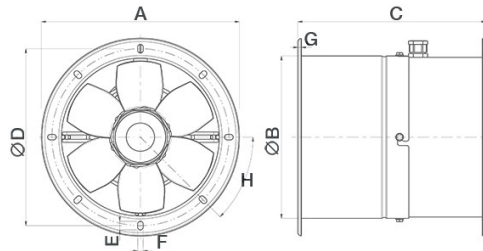

| | |
|-------------|-------|
| Size A (mm) | ∅ 432 |
| Size B (mm) | ∅ 368 |
| Size C (mm) | 330 |
| Size D (mm) | ∅ 405 |
| Size E (mm) | 14 |
| Size F (mm) | 9 |
| Size G (mm) | 4 |
| Size H (mm) | 45° |

PER INFORMAZIONI / FOR INFORMATION

ITALY

Pre Sales:
prevendita@vortice-italy.com
After Sales:
postvendita@vortice-italy.com

UNITED KINGDOM & REP. OF

IRELAND
Sales Dept:
sales@vortice.ltd.uk
Technical Dept:
technical@vortice.ltd.uk

OTHER COUNTRIES

Sales Dept:
export@vortice-italy.com
After Sales:
after-sales@vortice-italy.com

Technical Data Sheet

CODE 42217

MPC-E 354 M

Medium-pressure long cased axial fans



DESCRIPTION

- Nominal diameter 350 mm
- 2 rolled steel flange sections, welded, phosphated and polyester powder coated in practical grey colour with hammered effect finish, guaranteeing long-term resistance to atmospheric agents.
- 1 speed single phase AC motor with shaft turning in double shielded ball bearings, insulation class F.
- Maximum air flow: 3,500 m³/h.
- Impeller with 6 wing profile blades, dynamically balanced (UNI ISO 1940 – Balancing class 6.3), optimized to deliver maximum performance and low noise levels, moulded from filled polypropylene for superior dimensional stability and resistance to atmospheric agents, and keyed to a diecast aluminium hub.
- Vortice speed controller.

CURVES

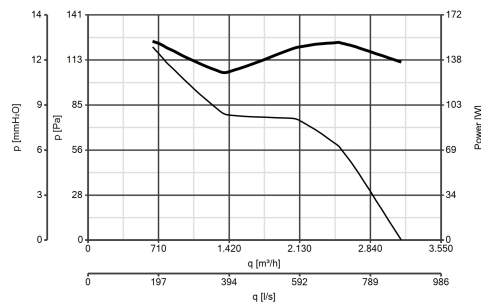

ACCESSORIES



IREM 3 CD 99250080

Code 12931

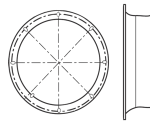

MPC BO 350 (BOCCAGLIO)

Code 22537

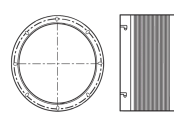

MPC RA 350 (RACCORDO FLESSIBILE)

Code 22518

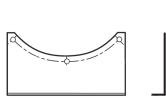

MPC SU 350 (SUPPORTO)

Code 22533

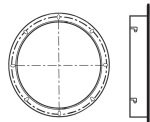

MPC FL 350 (FLANGIA)

Code 22525

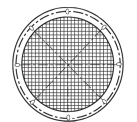

MPC RP 350 (RETE DI PROTEZIONE)

Code 22529



IRM 40

Code 12922

PER INFORMAZIONI / FOR INFORMATION

ITALY

Pre Sales:
prevendita@vortice-italy.com
After Sales:
postvendita@vortice-italy.com

UNITED KINGDOM & REP. OF

IRELAND
Sales Dept:
sales@vortice.ltd.uk
Technical Dept:
technical@vortice.ltd.uk

OTHER COUNTRIES

Sales Dept:
export@vortice-italy.com
After Sales:
after-sales@vortice-italy.com

