

KVR 3015 EC 30

131337

- Backward curved radial impeller
- Removable fan unit
- Housing made of galvanized sheet steel
- High efficiency EC motor, steplessly controllable
- Conveyed medium temperature up to 60 °C in continuous operation



MAP

Name	Value	Unit
Volume flow	0	m ³ /h
Pressure	0	Pa

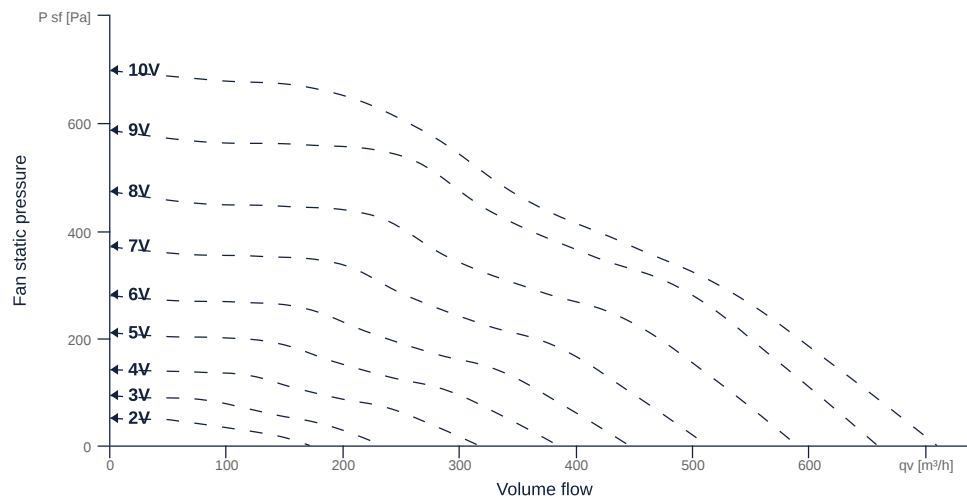

zur Produktseite

GENERAL DATA

Name	Value	Unit	Formula symbol
ERP conformity	Yes		
Certifications	CE, UKCA		
Duct size	300x150		WxH _{duct}
Pipe connection size (DN)	-		DN
Rated voltage (entire device)	230	V	U _{rated}
Phases (entire device)	1~		phase
Electrical protection (entire device)	6 A		fuse
Housing material	Galvanized steel		mat _{casing}
Impeller material	Plastic		mat _{impeller}
IP-protection class (entire device)	IPX4		IP _{compl}
IP-Protection class (terminal box)	IP44		IP _{ebox}
Weight	6.1	kg	m
Nominal air flow rate, nominal point m ³ /h	226.8	m ³ /h	q _{v,nom}
Nominal external pressure, static	310.9	Pa	p _{s,nom}
Fan type	Radial		Fan _{type}
Category / Installation situation	A		cat

ERP DATA (LOT 6)

Name	Value	Unit	Formula symbol
Nominal air flow rate, nominal point m ³ /s	0.06	m ³ /s	q _{v,nom}
Actual electrical input power, nominal point	0.04	kW	P _{e,nom}
Face velocity, nominal point	1.4	m/s	v _{nom}
Nominal external pressure, static	310.9	Pa	p _{s,nom}
supply air fan static efficiency, nominal point	45.8	%	η _{es,SUP}
Enclosure sound level, nominal point	70	dB(A)	L _{WA2}
Rating	Product is compliant 2018		



KVR 3015 EC 30

131337

ruck

MAXIMAL DATA

Name	Value		Unit	Formula symbol
	50 Hz	60 Hz		
Max. power consumption (device)	107	107	W	$P_{ed, max}$
Max. operating current (device)	0.91	0.91	A	$I_{ed, max}$
Max. speed	3620	3620	1/min	n_{max}
Max. stat. efficiency	41.2	41.2	%	η_{es}
Max. fan efficiency	41.6	41.6	%	η_e
Max. flowrate	710	710	m ³ /h	$Q_{v, max}$
Max. stat pressure	700	700	Pa	$p_{st, max}$
Max. medium temperature	60	60	°C	$T_{m, max}$
Max. environment temperature	60	60	°C	$T_{amb, max}$
Min. environment temperature	-30	-30	°C	$T_{amb, min}$

zur Produktseite



KVR 3015 EC 30

131337

SCHALTPLÄNE / MASSZEICHNUNGEN

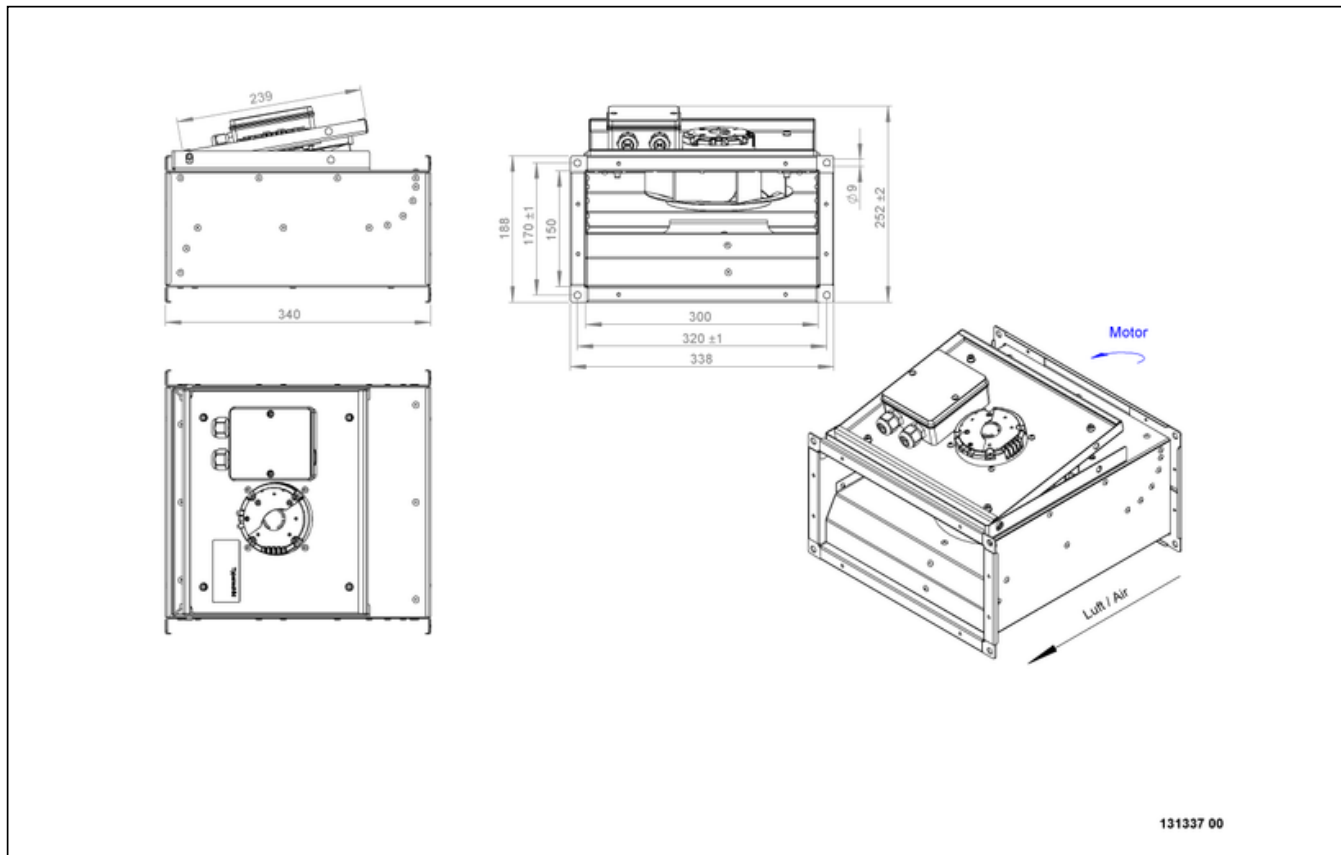

zur Produktseite

KVR 3015 EC 30

131337

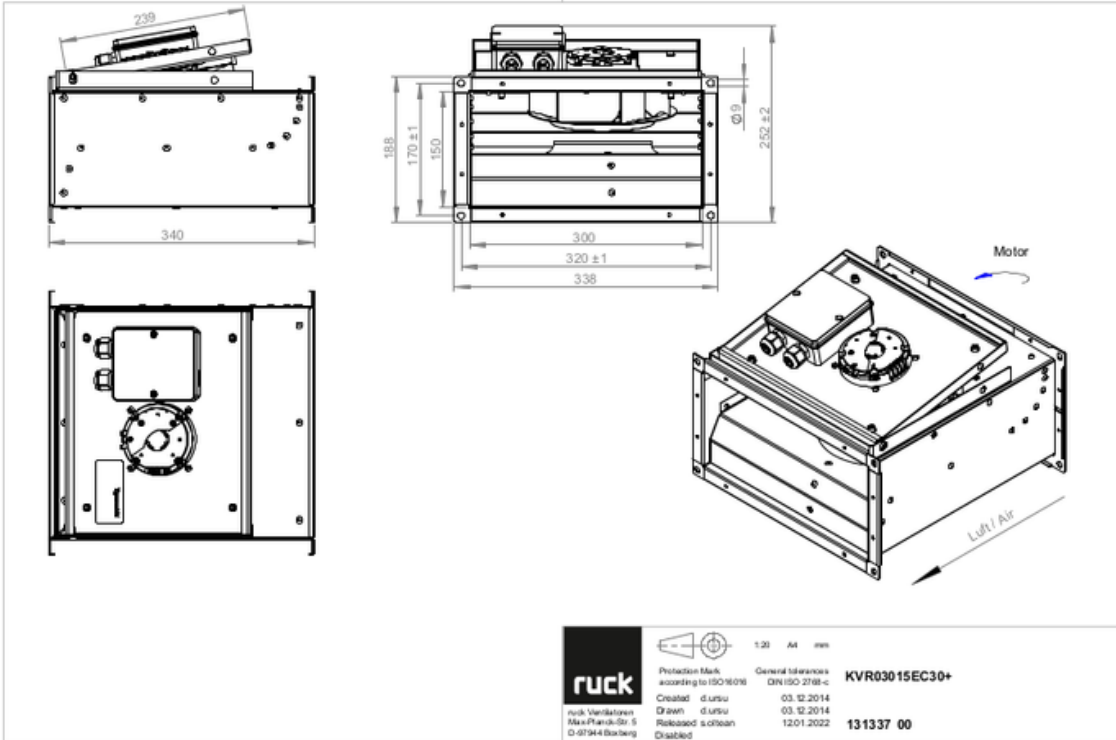

zur Produktseite

KVR 3015 EC 30

131337

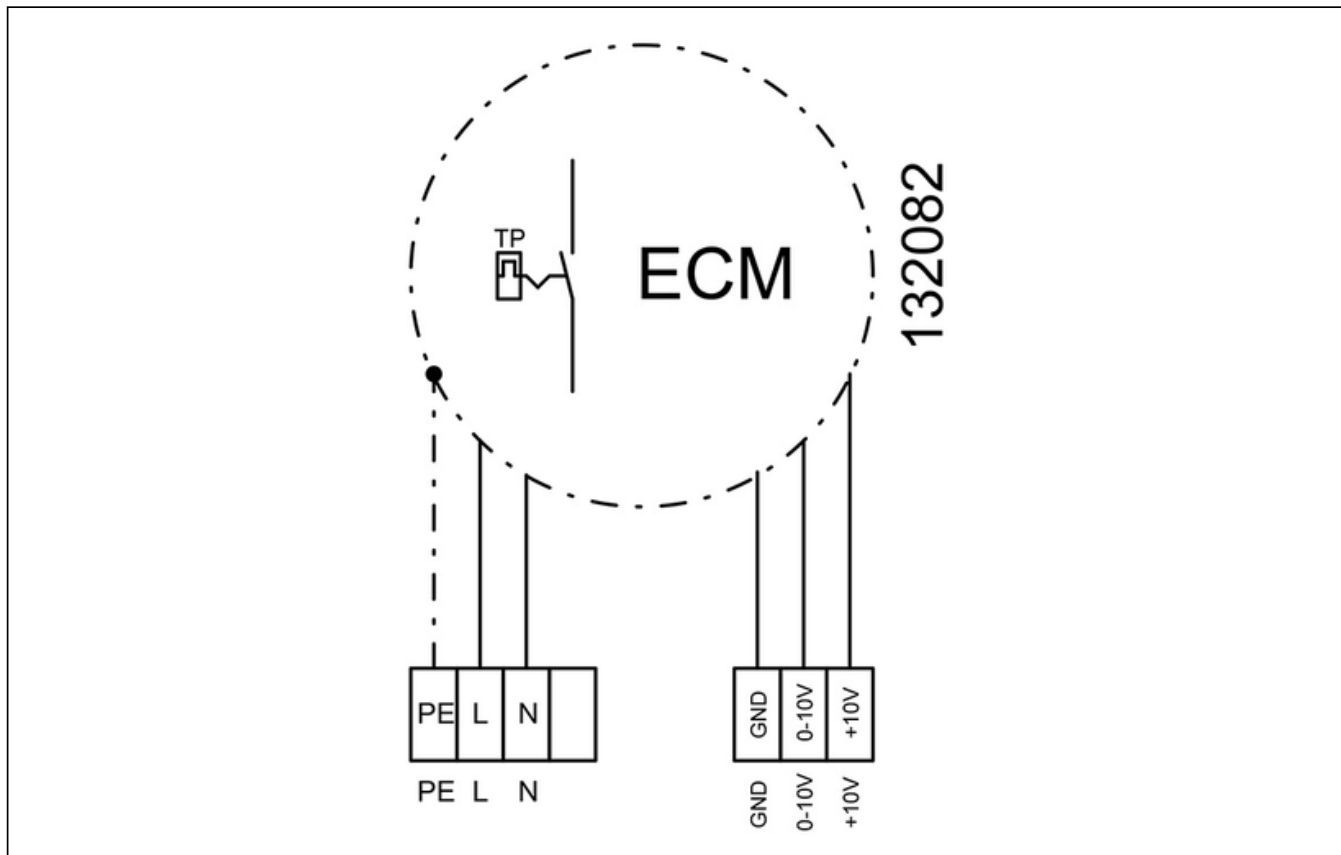

zur Produktseite

KVR 3015 EC 30

131337

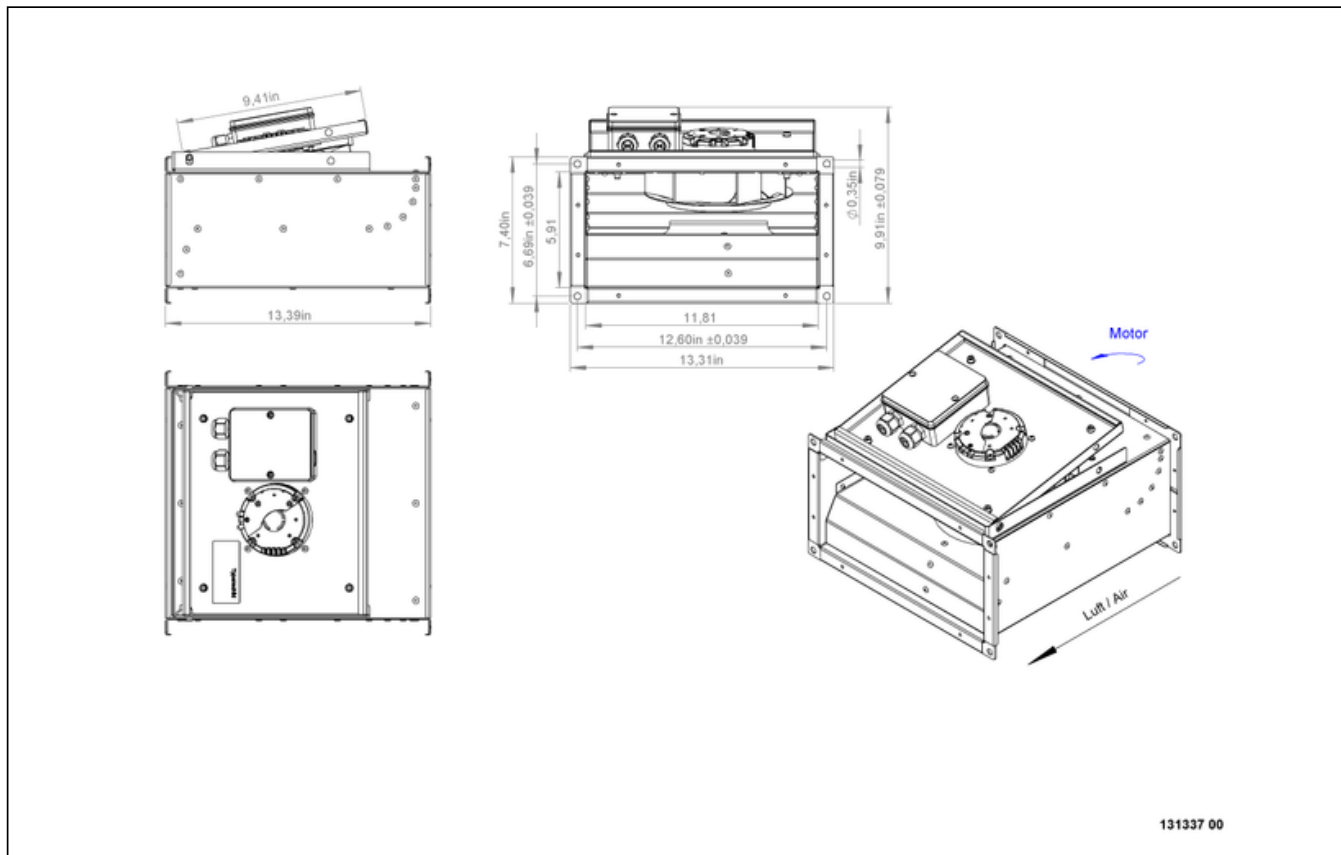

KVR 3015 EC 30

131337

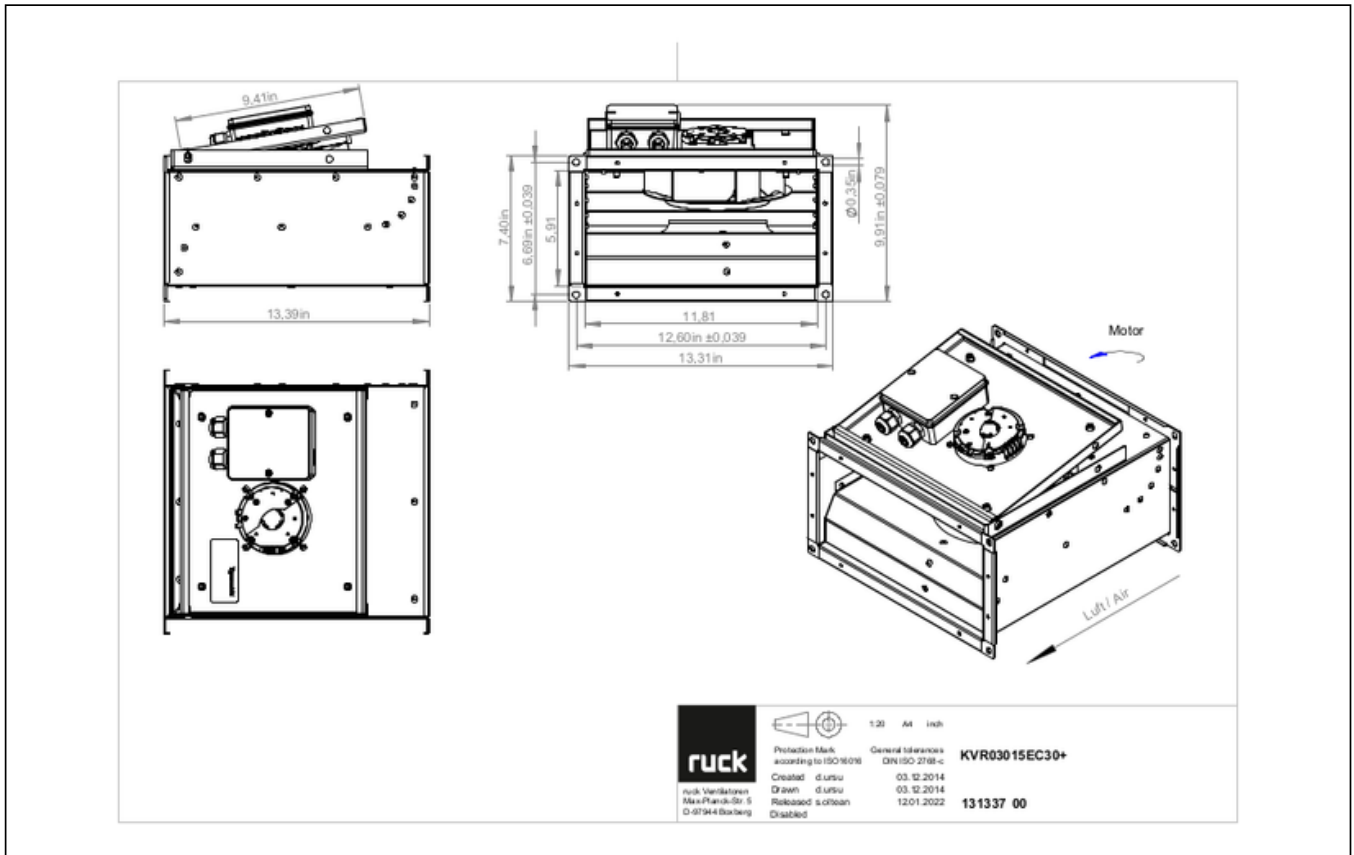

MECHANICAL ACCESSORIES

VS 3015 | 102801



- Duct connector, flexible
- Standard profile flange P20
- Galvanized steel sheet, plastic band (PVC)
- Temperature resistant up to 70 °C

VKK 3015 | 103897



- Automatic shutter
- Plastic, weather resistant
- Temperature resistant up to 70 °C



KVR 3015 EC 30

131337

ELECTRICAL ACCESSORIES

GS 03 | 107633



- Device switch
- $U_{max} = 400\text{ V}$, $I_{max} = 25\text{ A}$
- Switching capacity $400\text{ V } 3\text{-} = 5,5\text{ kW}$
- Protection class IP 55

CON P1000 | 115259



- Constant pressure control
- Actual value display possible via optional control unit
- Output 0-10 V DC + FC enable + setpoint reached
- Pressure setting by means of decade switch

MTP 20 | 128146



- Potentiometer 10 k Ω
- Switching contact 1A/250V AC - 2,5A/12V DC
- Max. ambient temperature 50 °C
- VDE

MTP 30 | 143289



- Stepped potentiometer 10 k Ω
- Step 1 + 2 settable 10 % - 100 % Vdc
- Step 3 100 % Vdc
- Supply voltage +10 Vdc

MTP 40 | 147359



- Potentiometer 10 k Ω
- Connection in terminal box
- Max. ambient temperature 50 °C
- PU: 20 pieces

MTP 50 | 153133



- Potentiometer with multifunction output
- 230 VAC $\pm 10\%$ / 50-60 Hz
- Selectable output: 1-10 VDC / 2-20 mA / 10-100 % PWM
- Min. and max. output value adjustable



zur Produktseite