

# DZQ 50/6 B

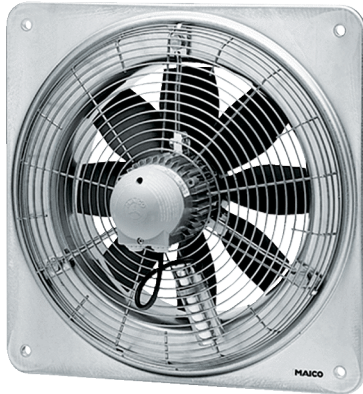

## Short description

Axial wall fan with square wall plate, DN 500, three-phase AC

## Application examples

Production facility, Commercial premises, Garage, Building container, Storage facility

Article number 0083.0130

## Technical data

Model	Square wall plate
Air flow volume	5.880 m <sup>3</sup> /h
Air volume <sub>nom</sub>	4.350 m <sup>3</sup> /h (in opt. efficiency)
Pressure p <sub>fs, nom</sub>	60 Pa (in opt. efficiency)
Rotating speed n <sub>nom</sub>	950 1/min (in opt. efficiency)
Rotating speed	968 1/min
Impeller type	axial
Speed controllable	✓
Reversing capacity	✓
Type of voltage	Three-phase AC
Rated voltage	400 V
Frequency	50 Hz
Nominal output	240 W (in opt. efficiency)
I <sub>nom</sub>	0,7 A (in opt. efficiency)
I <sub>max</sub>	0,8 A
Degree of protection	IP 55
Insulation class	F
Pole-changeable	–
Mains cable	7 x 1,5 mm <sup>2</sup>
Installation site	Wall / Ceiling
Type of installation	Surface-mounted
Installation position	horizontal / vertical
Material	Sheet steel, galvanised
Colour	Silver
Weight	17,53 kg
Weight including packaging	21,31 kg
Nominal size	500 mm
Width	700 mm
Height	700 mm

# DZQ 50/6 B

Depth	329 mm
Width with packaging	730 mm
Height with packaging	730 mm
Depth with packaging	400 mm
Airstream temperature at nominal current	60 °C
Airstream temperature at $I_{Max}$	-20 °C up to 60 °C
Packing unit	1 piece
Range	C
GTIN (EAN)	4012799831303

## Technical data according to ErP in Best Efficiency Point (BEP)

Total efficiency $\eta$	30,2 %
Measurement category	A
Efficiency category	static
Efficiency level N	40,4
VSD necessary	No
Year of manufacture	see rating plate
Manufacturer's name / official registration number / manufacturer's place of establishment	Maico Elektroapparate-Fabrik GmbH / Freiburg registration court, HRB 601233 / Villingen-Schwenningen
Art. No.	0083.0130
$P_{BEP}$ / Air volume $_{BEP}$ / $P_{fs, BEP}$	0,24 kW / 4.350 m <sup>3</sup> /h / 60 Pa
$n_{BEP}$	950 1/min
Specific ratio	$\approx 1$
Information about dismantling and disposal	see mounting instructions
Information about installation, operation and repairs	see mounting instructions
Objects used to measure efficiency which are not described by the measurement category	-
Sound power level $_{L_{WA7}}$	73 dB(A)

## Sound power level in octave range

	63 Hz	125 Hz	250 Hz	500 Hz	1 kHz	2 kHz	4 kHz	8 kHz	Total
$L_{WA7, S1}$ (dB(A))	-	-	-	-	-	-	-	-	54
$L_{WA7, S2}$ (dB(A))	-	-	-	-	-	-	-	-	63
$L_{WA7, S3}$ (dB(A))	-	-	-	-	-	-	-	-	68
$L_{WA7, S4}$ (dB(A))	-	-	-	-	-	-	-	-	71
$L_{WA7, S5}$ (dB(A))	34	53	57	63	68	68	63	52	73

# DZQ 50/6 B

	63 Hz	125 Hz	250 Hz	500 Hz	1 kHz	2 kHz	4 kHz	8 kHz	Total
$L_{WA8, S1}$ (dB(A))	-	-	-	-	-	-	-	-	65
$L_{WA8, S2}$ (dB(A))	-	-	-	-	-	-	-	-	74
$L_{WA8, S3}$ (dB(A))	-	-	-	-	-	-	-	-	76
$L_{WA8, S4}$ (dB(A))	-	-	-	-	-	-	-	-	77
$L_{WA8, S5}$ (dB(A))	52	59	61	65	71	72	73	70	78

$L_{WA7}$  = housing and free inlet sound power level in dB.  
 $L_{WA8}$  = housing and free outlet sound power level in dB.

## Characteristic curve

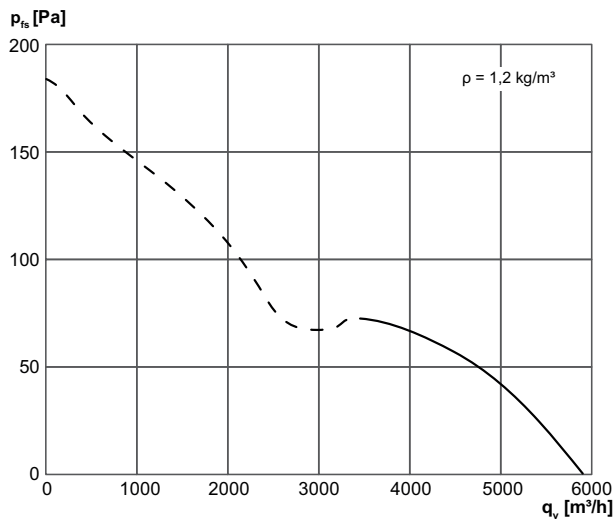

## Dimensioned drawing [mm]

- ① Steel wall plate = EZQ/DZQ model
- ② Steel wall ring = EZS/DZS model

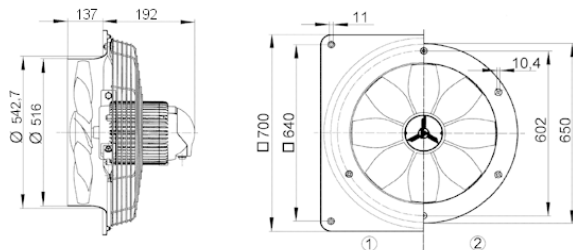

DZQ 50/6 B

