

Technical parameters

Nominal data	
Voltage (nominal)	400 V
Frequency	50 Hz
Phases	3~
Motor circuit connection	Y
Input power	1,412 W
Starting current	11 A
Input current	2.8 A
Impeller speed	1,424 rpm
Air flow	max 8,050 m ³ /h
Max. Temperature of transported air for 120 min	400 °C
Temperature of transported air	max 120 °C
Sound data	
Sound pressure level at 3m (20m ² Sabin)	64 dB(A)
Protection/Classification	
Enclosure class, motor	IP55
Insulation class	F
Data according to ErP	
ErP ready	Not ErP relevant
Dimensions and weights	
Weight	94 kg
Others	
Duct connection type	Rectangular
Motor type	AC

Dimension

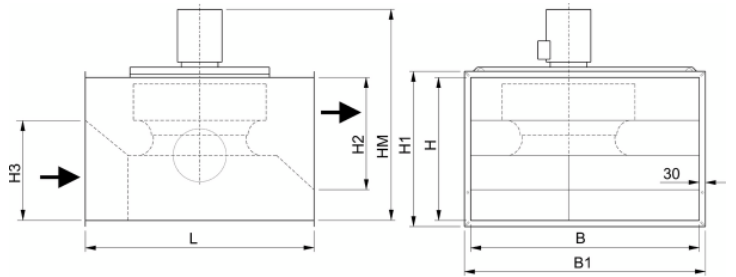

	B	H	L	B1	H1	H2	H3	-HM
BKF 500D4-XS, D6-XS, D4-6-XS	900	630	900	960	690	520	520	920

Wiring

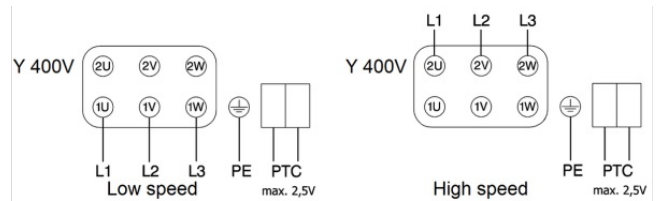

Left connection: low speed

Right connection: high speed

Performance curve

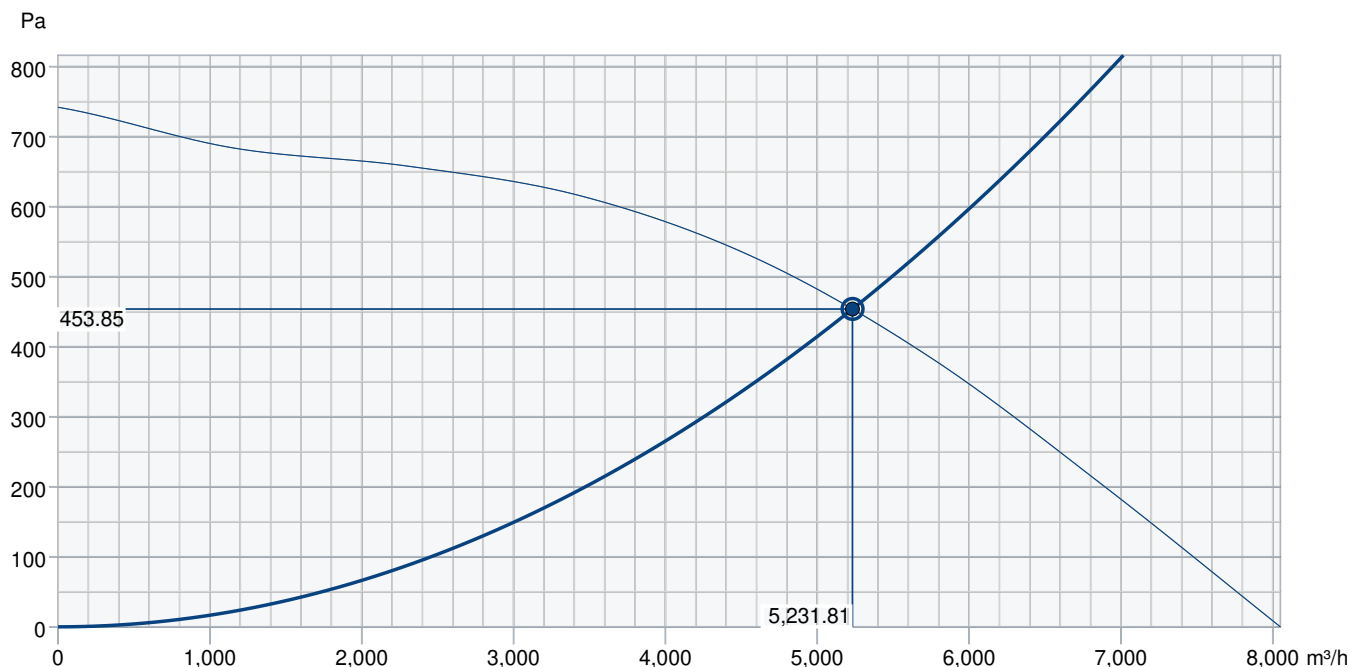

Hydraulic data

Required air flow	5,232 m³/h
Required static pressure	454 Pa
Working air flow	5,232 m³/h
Working static pressure	454 Pa
Air density	1.204 kg/m³
Power	1,419.1 W
Fan control - RPM	1,424 rpm
Current	2.86 A
SFP	0.976 kW/m³/s
Control voltage	400.0 V
Supply voltage	400 V

Accessories

U-EK230E Motor protection (30199)
FLC BKF 500-560 (95736)
U-EK plastic housing IP65 (298149)

DRAIN NIPPLE BKF (95458)
PG-BKF 500-560 (95746)
WPR BKF 500-560 (95741)

Documents

BKF_E8306_15_06_2017.pdf
IMO_BKF
BKF_500_560_00.dxf
Certificate-DVV-DVG-BKF-MRH-CPR-597958