

Technical parameters

Nominal data	
Voltage (nominal)	400 V
Frequency	50 Hz
Phases	3~
Motor circuit connection	Y
Input power	963 W
Starting current	9 A
Input current	2.5 A
Impeller speed	1,428 rpm
Air flow	max 5,861 m ³ /h
Max. Temperature of transported air for 120 min	400 °C
Temperature of transported air	max 120 °C
Sound data	
Sound pressure level at 3m (20m ² Sabin)	63 dB(A)
Protection/Classification	
Enclosure class, motor	IP55
Insulation class	F
Data according to ErP	
ErP ready	Not ErP relevant
Dimensions and weights	
Weight	72 kg
Others	
Duct connection type	Rectangular
Motor type	AC

Dimension

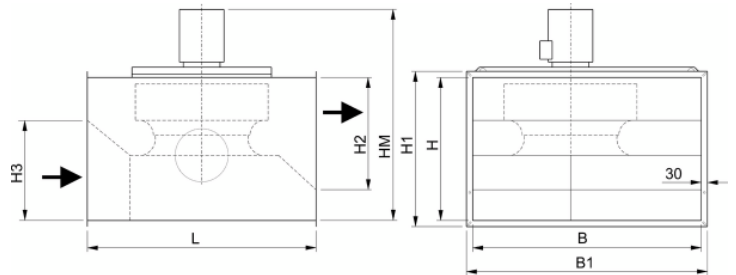

	B	H	L	B1	H1	H2	H3	-HM
BKF 450D4-6, D4-8	800	500	780	860	560	420	420	765

Wiring

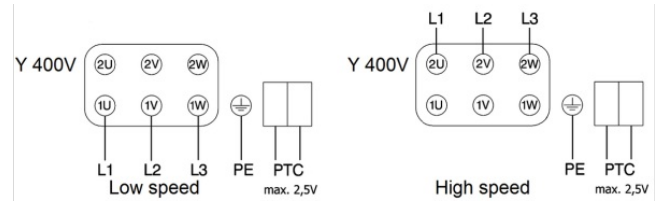

Left connection: low speed

Right connection: high speed

Performance curve

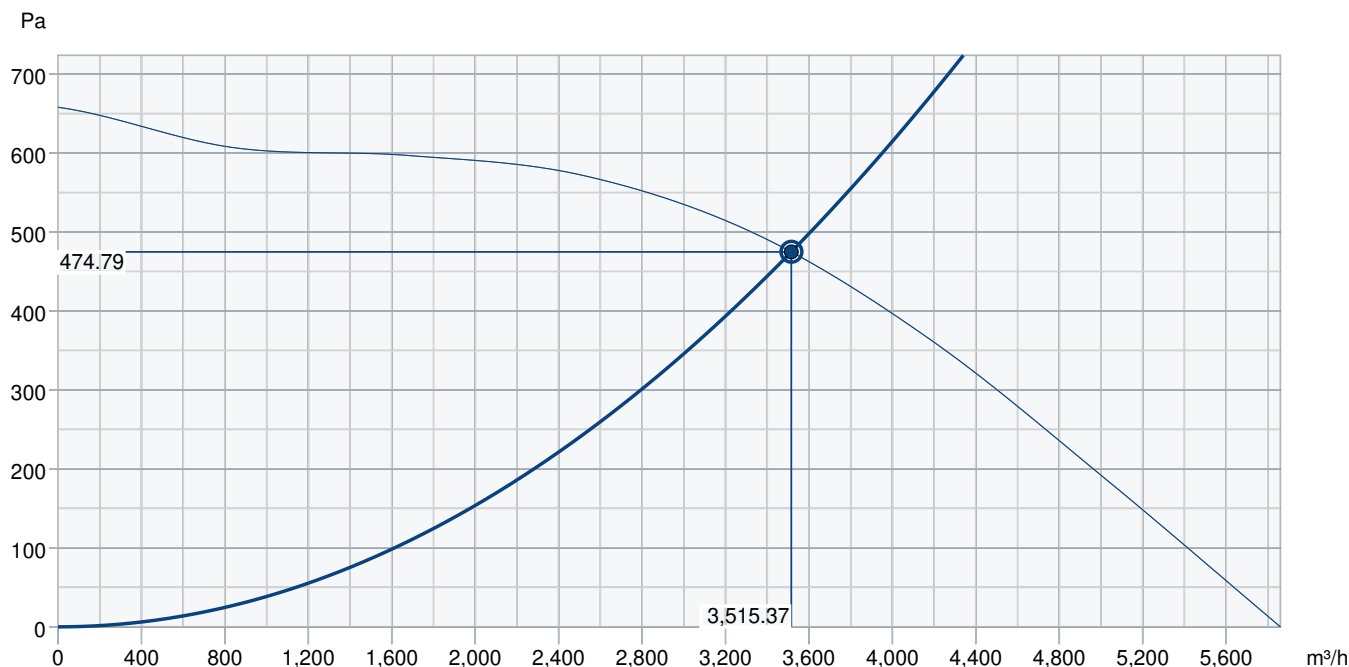

Hydraulic data

Required air flow	3,516 m³/h
Required static pressure	475 Pa
Working air flow	3,515 m³/h
Working static pressure	475 Pa
Air density	1.204 kg/m³
Power	963.4 W
Fan control - RPM	1,428 rpm
Current	2.50 A
SFP	0.987 kW/m³/s
Control voltage	400.0 V
Supply voltage	400 V

Accessories

U-EK230E Motor protection (30199)
FLC BKF 400-450 (95735)
U-EK plastic housing IP65 (298149)

DRAIN NIPPLE BKF (95458)
PG-BKF 400-450 (95745)
WPR BKF 400-450 (95740)

Documents

BKF_E8306_15_06_2017.pdf
IMO_BKF
BKF_400_450_m90_00.dxf
Certificate-DVV-DVG-BKF-MRH-CPR-597958