

## Technical parameters

Nominal data	
Voltage (nominal)	400 V
Frequency	50 Hz
Phases	3~
Motor circuit connection	Y
Input power	315 W
Starting current	4.4 A
Input current	1 A
Impeller speed	1,451 rpm
Air flow	max 2,632 m <sup>3</sup> /h
Max. Temperature of transported air for 120 min	400 °C
Temperature of transported air	max 120 °C
Sound data	
Sound pressure level at 3m (20m <sup>2</sup> Sabin)	58 dB(A)
Protection/Classification	
Enclosure class, motor	IP55
Insulation class	F
Data according to ErP	
ErP ready	Not ErP relevant
Dimensions and weights	
Weight	51 kg
Others	
Duct connection type	Rectangular
Motor type	AC

## Dimension

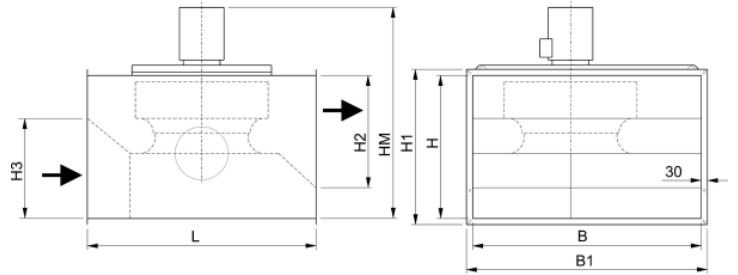

	B	H	L	B1	H1	H2	H3	~HM
BKF 315D4-XL, D6-XL, D4-6-XL, D4-8-XL	630	400	710	690	460	-	-	641

## Wiring

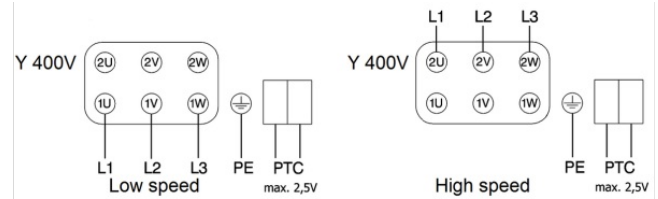

Left connection: low speed

Right connection: high speed

## Performance curve

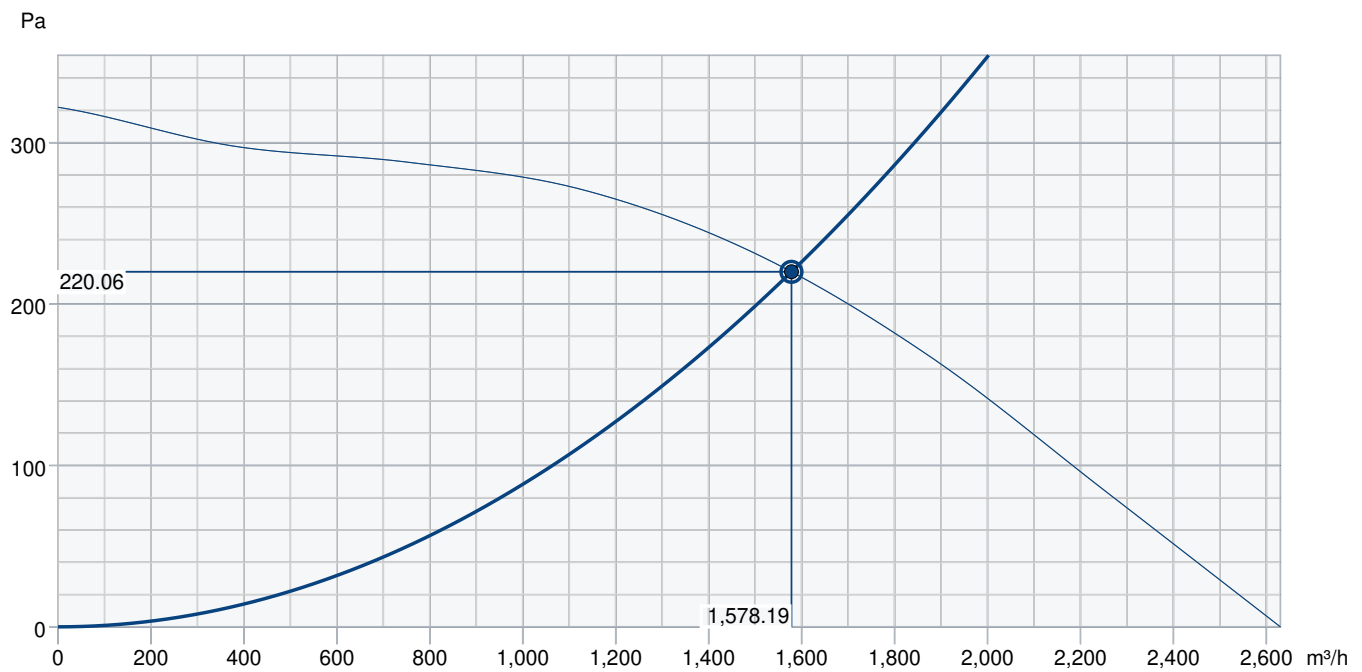

### Hydraulic data

Required air flow	1,578 m³/h
Required static pressure	220 Pa
Working air flow	1,578 m³/h
Working static pressure	220 Pa
Air density	1.204 kg/m³
Power	315.1 W
Fan control - RPM	1,451 rpm
Current	1.00 A
SFP	0.719 kW/m³/s
Control voltage	400.0 V
Supply voltage	400 V

### Accessories

U-EK230E Motor protection (30199)  
FLC BKF 315-355 (95734)  
U-EK plastic housing IP65 (298149)

DRAIN NIPPLE BKF (95458)  
PG-BKF 315-355 (95744)  
WPR BKF 315-355 (95739)

## Documents

BKF\_E8306\_15\_06\_2017.pdf  
IMO\_BKF  
BKF\_315\_355\_02.dxf  
Certificate-DVV-DVG-BKF-MRH-CPR-597958  
DoP\_BKF